

Residential

1,550 Sqft - 202 Empie Avenue, Topsail Beach,
 North Carolina 28445

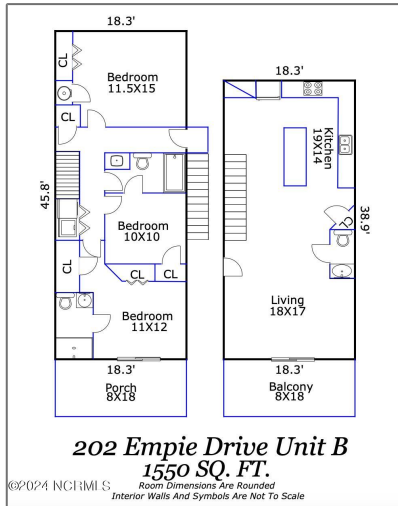

Basic Details

Property Type:	Residential
Listing Type:	For Sale
Listing ID:	100439798
Price:	\$749,900
Bedrooms:	3
Rooms:	5
Bathrooms:	3
# Baths - Full:	2
Half Bathrooms:	1
Square Footage:	1,550 Sqft
Year Built:	1991
List Price/SqFt:	\$484
Status:	Active
Days on Market:	14

Features

✓ Heating System:	Heat Pump, Forced Air
Total # Garage Spaces:	2
✓ Rooms: Kitchen Level:	Third
✓ Flooring:	Carpet, Lvt/lvp
✓ Roof:	Architectural Shingle
✓ Appliances/Equip:	Refrigerator, Stove/oven - Electric, Microwave - Built-in
✓ Road Type/Frontage:	Public (city/cty/st), Paved
✓ Interior Features:	Foyer, Walk-in Shower, Ceiling Fan(s), Ceiling - Vaulted, Reverse Floor Plan, Kitchen Island

Address [Information](#)

Country:	US
State:	NC
County:	Pender
City:	Topsail Beach
Subdivision:	Topsail Inlet Terrace
Zipcode:	28445
Street:	Empie
Street Number:	202
Street Suffix:	Avenue

Additional [Information](#)

Office Name:	Century 21 Vanguard
<input checked="" type="checkbox"/> Sub-Type:	Townhouse
Tax Year:	01/01/1970
Waterview:	Yes
Office ID:	2022052616080957 6648000000
Agent ID:	2015120919314549 0103000000
UnBranded Virtual Tour:	https://my.matterport.com/show/?m=RvMU6aLnp6A&play=1&brand=0&mls=1&
<input checked="" type="checkbox"/> Foundation:	Pilings
<input checked="" type="checkbox"/> Construction Type:	Stick Built
<input checked="" type="checkbox"/> Construction:	Wood Frame
New Construction:	No
Stories:	2

Neighborhood

Elementary School:	North Topsail
Middle School:	Topsail
High School:	Topsail

Waterfront:	No
✓ Porch/Balcony/Deck:	Deck, Patio, Open
✓ Water Heater:	Electric
✓ Exterior Finish:	Vinyl Siding
✓ Lot Water Features:	Third Row
HOA:	No
SqFt - Heated:	0 Sqft
Lot SqFt:	0 Sqft
✓ HOA Amenities:	No Amenities
Garage:	0

Agent [Info](#)



Living Seaside Realty Group
☎ 910-239-3201
☎ +1(910) 227-9439
✉ home@livingseaside.com

910-239-3201 - 6314 Oleander Dr. Wilmington, NC 28403