

Residential

1,283 Sqft - 2932 New Town Drive, Wilmington,
 North Carolina 28405

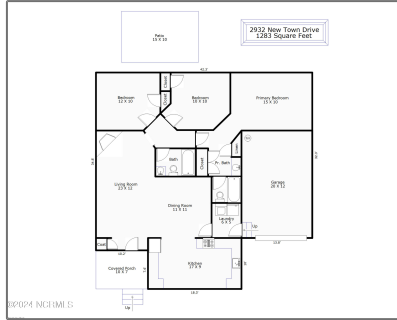

Basic Details

Property Type: **Residential**

Listing Type: **Sold**

Listing ID: **100428749**

Price: **\$280,000**

Bedrooms: **3**

Rooms: **7**

Bathrooms: **2**

Baths - Full: **2**

Square Footage: **1,283 Sqft**

Year Built: **1986**

Lot Area: **0.20 Acre**

List Price/SqFt: **\$225**

Status: **Closed**

Days on Market: **10**

Sold Price: **\$280,000**

Close Date: **04/02/2024**

Sold Price/SqFt: **\$218**

Features

✓ Heating System: **Heat Pump, Forced Air**

✓ Fireplace: **1**

Total # Garage Spaces: **1**

✓ Rooms: Kitchen Level: **First**

✓ Flooring: **Tile**

✓ Roof: **Shingle**

✓ Appliances/Equip: **Dishwasher, Refrigerator, Stove/oven - Electric**

✓ Road Type/Frontage: **Paved**

✓ Interior Features: **1st Floor Master, Ceiling - Vaulted**

Address [Information](#)

Country:	US
State:	NC
County:	New Hanover
City:	Wilmington
Subdivision:	Northchase
Zipcode:	28405
Street:	New Town
Street Number:	2932
Street Suffix:	Drive

Additional [Information](#)

Office Name:	Berkshire Hathaway HomeServices Carolina Premier Properties
<input checked="" type="checkbox"/> Sub-Type:	Single Family Residence
Tax Year:	01/01/1970
Waterview:	Yes
Office ID:	2015120914415332 8968000000
Agent ID:	2015120919295277 7908000000
UnBranded Virtual Tour:	<a href="http://sites.unique
mediadesign.com/2
932newtowndrive?
mls">http://sites.unique mediadesign.com/2 932newtowndrive? mls
<input checked="" type="checkbox"/> Foundation:	Slab
<input checked="" type="checkbox"/> Construction Type:	Stick Built
<input checked="" type="checkbox"/> Construction:	Wood Frame
New Construction:	No
Stories:	1

Neighborhood

Elementary School:	Castle Hayne
Middle School:	Trask
High School:	Laney

Waterfront:	No
✓ Porch/Balcony/Deck:	Porch, Patio, Covered
✓ Water Heater:	Electric
✓ Attic:	Access Only
✓ Exterior Finish:	Brick Veneer, Vinyl Siding
HOA:	Yes
SqFt - Heated:	0 Sqft
Lot SqFt:	8,843 Sqft
✓ HOA Amenities:	Playground, Community Pool, Tennis Court(s)
Garage:	1

Agent [Info](#)



Living Seaside Realty Group
☎ 910-239-3201
☎ +1(910) 227-9439
✉ home@livingseaside.com

910-239-3201 - 6314 Oleander Dr. Wilmington, NC 28403