

Residential

2,317 Sqft - 5149 Sweet Tea Avenue, Wilmington,
 North Carolina 28412

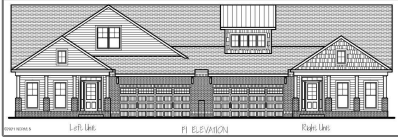

Basic Details

Property Type: **Residential**

Listing Type: **Sold**

Listing ID: **100435223**

Price: **\$541,600**

Bedrooms: **4**

Rooms: **7**

Bathrooms: **3**

Baths - Full: **3**

Square Footage: **2,317 Sqft**

Year Built: **2024**

Lot Area: **0.14 Acre**

List Price/SqFt: **\$234**

Status: **Closed**

Days on Market: **1**

Sold Price: **\$541,600**

Close Date: **04/11/2024**

Sold Price/SqFt: **\$234**

Features

✓ Heating System: **Forced Air**

✓ Fireplace: **1**

Total # Garage Spaces: **2**

✓ Rooms: Kitchen Level: **First**

✓ Flooring: **Carpet, Tile, Wood**

✓ Roof: **Shingle**

✓ Appliances/Equip: **Dishwasher, Stove/oven - Electric, Microwave - Built-in, Disposal**

✓ Road Type/Frontage: **Public (city/cty/st), Paved**

✓ Interior Features: **1st Floor Master, Foyer, Gas Logs, Walk-in Closet, Ceiling Fan(s), Ceiling - Trey, Blinds/shades, Pantry**

✓ Exterior Features: **Irrigation System**

Address Information

Country: **US**

Neighborhood

Elementary School: **Williams**

State:	NC	Middle School:	Myrtle Grove
County:	New Hanover	High School:	New Hanover
City:	Wilmington		
Subdivision:	Riverlights		
Zipcode:	28412		
Street:	Sweet Tea		
Street Number:	5149		
Street Suffix:	Avenue		

Additional [Information](#)

Office Name:	Coldwell Banker Sea Coast Advantage-Leland
--------------	--------------------------------------------------

✓ Sub-Type:	Townhouse
-------------	-----------

Tax Year:	01/01/1970
Waterview:	Yes

Office ID:	2015120914421013 4263000000
Agent ID:	2024010821082873 1828000000

✓ Foundation:	Slab
---------------	------

✓ Construction Type:	Stick Built
----------------------	-------------

✓ Construction:	Wood Frame
-----------------	------------

New Construction:	Yes
-------------------	-----

Stories:	2
Waterfront:	No

✓ Porch/Balcony/Deck:	Porch, Screened, Covered
-----------------------	--------------------------

✓ Water Heater:	Natural Gas
-----------------	-------------

✓ Attic:	Walk-in
----------	---------

✓ Exterior Finish:	Fiber Cement
--------------------	--------------

HOA: **Yes**

SqFt - Heated: **0 Sqft**

Lot SqFt: **6,098 Sqft**

✓	HOA Amenities:	Clubhouse, Maint - Comm Areas, Maint - Grounds, Maint - Roads, Playground, Termite Bond, Water, Fitness Center, Master Insure, Street Lights, Sidewalk, Restaurant, Community Pool, Taxes, Management, Trail(s), Picnic Area, Gated, Maintenance Structure
---	----------------	------------------------------------------------------------------------------------------------------------------------------------------------------------------------------------------------------------------------------------------------------------

Garage: **2**

Agent [Info](#)



Living Seaside Realty Group
📞 910-239-3201
📞 +1(910) 227-9439
✉ home@livingseaside.com

910-239-3201 - 6314 Oleander Dr. Wilmington, NC 28403