

# Residential

1,434 Sqft - 734 Greenwich Place, Richlands,  
North Carolina 28574

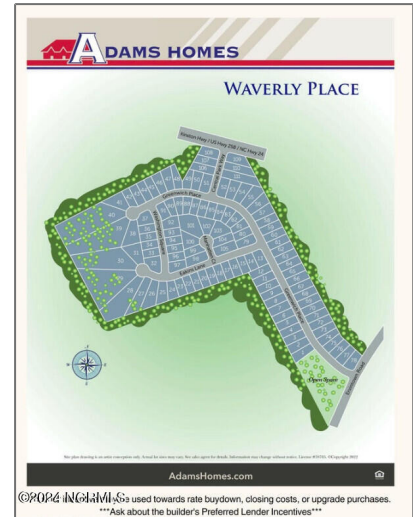
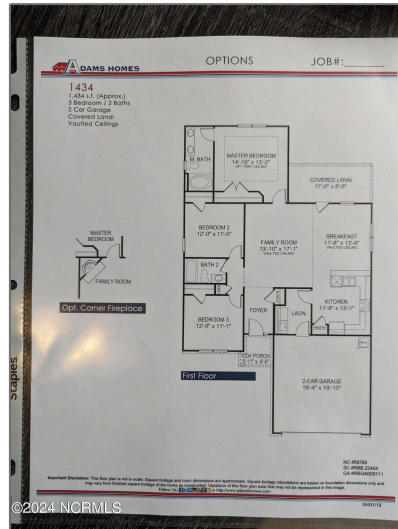

## Basic Details

Property Type:	Residential
Listing Type:	For Sale
Listing ID:	100430735
Price:	\$304,400
Bedrooms:	3
Rooms:	6
Bathrooms:	2
# Baths - Full:	2
Square Footage:	1,434 Sqft
Year Built:	2024
Lot Area:	0.23 Acre
List Price/SqFt:	\$212
Status:	Active
Days on Market:	7

## Features

✓	Heating System:	Heat Pump
✓	Fireplace:	1
Total # Garage Spaces:		2
✓	Roof:	Architectural Shingle
✓	Road Type/Frontage:	Maintained, Paved
✓	Interior Features:	1st Floor Master, 9ft+ Ceilings, Smoke Detectors, Walk-in Shower, Ceiling Fan(s), Ceiling - Vaulted, Pantry

Address [Information](#)

Country:	US
State:	NC
County:	Onslow
City:	Richlands
Subdivision:	Waverly Place
Zipcode:	28574
Street:	Greenwich
Street Number:	734
Street Suffix:	Place

Additional [Information](#)

Office Name:	ADAMS HOMES REALTY NC INC
<input checked="" type="checkbox"/> Sub-Type:	Single Family Residence
Tax Year:	01/01/1970
Waterview:	Yes
Office ID:	2022123013454189 8564000000
Agent ID:	2016030917434029 1547000000
<input checked="" type="checkbox"/> Foundation:	Slab
<input checked="" type="checkbox"/> Construction Type:	Stick Built
<input checked="" type="checkbox"/> Construction:	Wood Frame
New Construction:	Yes
Stories:	1
Waterfront:	No
<input checked="" type="checkbox"/> Porch/Balcony/Deck:	Porch, Covered
<input checked="" type="checkbox"/> Exterior Finish:	Stone, Vinyl Siding
HOA:	Yes

Neighborhood

Elementary School:	Heritage Elementary
Middle School:	Trexler
High School:	Richlands

SqFt - Heated:	<b>0 Sqft</b>
Lot SqFt:	<b>10,019 Sqft</b>
✓ HOA Amenities:	Maint - Comm Areas, Maint - Grounds, Street Lights
School District:	<b>Onslow</b>
Garage:	<b>2</b>

Agent [Info](#)

---



Living Seaside Realty Group  
☎ 910-239-3201  
☎ +1(910) 227-9439  
✉ home@livingseaside.com

910-239-3201 - 6314 Oleander Dr. Wilmington, NC 28403

---