

# Residential

1,023 Sqft - 1035 Course Lane, Surf City, North Carolina 28445

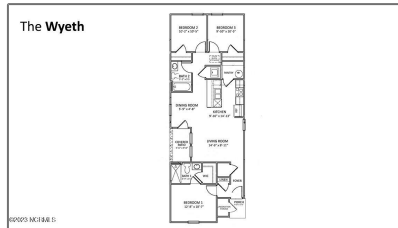

## Basic Details

Property Type: **Residential**

Listing Type: **Sold**

Listing ID: **100386127**

Price: **\$292,000**

Bedrooms: **3**

Rooms: **5**

Bathrooms: **2**

# Baths - Full: **2**

Square Footage: **1,023 Sqft**

Year Built: **2023**

Lot Area: **0.13 Acre**

List Price/SqFt: **\$291**

Status: **Closed**

Days on Market: **26**

Sold Price: **\$292,000**

Close Date: **09/14/2023**

Sold Price/SqFt: **\$285**

## Features

✓ Heating System: **Heat Pump**

Total # Garage Spaces: **0**

✓ Roof: **Composition**

✓ Appliances/Equip: **Dishwasher, Stove/oven - Electric, Microwave - Built-in, Disposal**

✓ Road Type/Frontage: **Private, Maintained, Paved**

✓ Interior Features: **1st Floor Master, Smoke Detectors, Walk-in Shower, Walk-in Closet, Pantry**

Address [Information](#)

Country:	US
State:	NC
County:	Pender
City:	Surf City
Subdivision:	Waterside
Zipcode:	28445
Street:	Course
Street Number:	1035
Street Suffix:	Lane

Additional [Information](#)

Office Name:	D.R. Horton, Inc
<input checked="" type="checkbox"/> Sub-Type:	Single Family Residence
Tax Year:	01/01/1970
Waterview:	Yes
Office ID:	2015120914421854 6021000000
Agent ID:	2023012015093129 4540000000
<input checked="" type="checkbox"/> Foundation:	Slab
<input checked="" type="checkbox"/> Construction Type:	Stick Built
<input checked="" type="checkbox"/> Construction:	Wood Frame
New Construction:	Yes
Stories:	1
Waterfront:	No
<input checked="" type="checkbox"/> Porch/Balcony/Deck:	Covered
<input checked="" type="checkbox"/> Exterior Finish:	Vinyl Siding
HOA:	Yes
SqFt - Heated:	0 Sqft

Neighborhood

Elementary School:	Surf City
Middle School:	Surf City
High School:	Topsail

Lot SqFt:

5,663 Sqft

✓

HOA Amenities:

Maint - Comm Areas,  
Maint - Roads,  
Playground, Fitness  
Center, Street Lights,  
Sidewalk, Pickleball,  
Community Pool,  
Management, Trail(s),  
Cabana

Garage:

0

Agent Info



Living Seaside Realty Group

📞

910-239-3201

📞

+1(910) 227-9439

✉

home@livingseaside.com

910-239-3201 - 6314 Oleander Dr. Wilmington, NC 28403