

# Residential

2,580 Sqft - 391 Autumn Pheasant Loop, Calabash,  
 North Carolina 28467

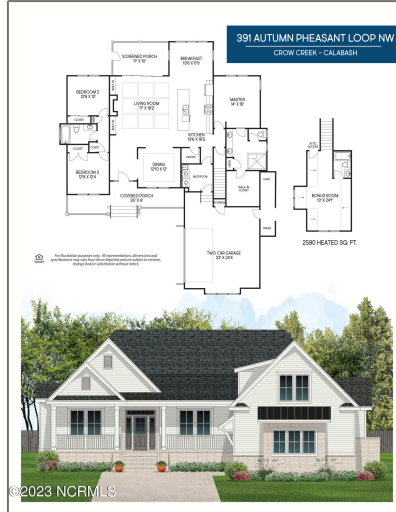

## Basic Details

Property Type:	<b>Residential</b>
Listing Type:	<b>For Sale</b>
Listing ID:	<b>100366360</b>
Price:	<b>\$699,000</b>
Bedrooms:	<b>3</b>
Rooms:	<b>9</b>
Bathrooms:	<b>3</b>
# Baths - Full:	<b>3</b>
Square Footage:	<b>2,580 Sqft</b>
Year Built:	<b>2023</b>
Lot Area:	<b>0.32 Acre</b>
List Price/SqFt:	<b>\$271</b>
Status:	<b>Active</b>
Days on Market:	<b>401</b>

## Features

✓ Heating System:	Forced Air, Fireplace(s), Fireplace Insert
✓ Fireplace:	1
Total # Garage Spaces:	2
✓ Flooring:	Carpet, Tile, Lvt/lvp
✓ Roof:	Architectural Shingle
✓ Appliances/Equip:	Dishwasher, Stove/oven - Electric, Microwave - Built-in, Disposal
✓ Road Type/Frontage:	Private, Paved
✓ Interior Features:	1st Floor Master, 9ft+ Ceilings, Foyer, Gas Logs, Smoke Detectors, Walk-in Shower, Walk-in Closet, Ceiling Fan(s), Ceiling - Trey, Pantry, Solid Surface, Kitchen Island

Address [Information](#)

Country:	US
State:	NC
County:	Brunswick
City:	Calabash
Subdivision:	Crow Creek
Zipcode:	28467
Street:	Autumn Pheasant
Street Number:	391
Street Suffix:	Loop

Additional [Information](#)

Office Name:	Keller Williams Innovate- Wilmington
<input checked="" type="checkbox"/> Sub-Type:	Single Family Residence
Tax Year:	01/01/1970
Waterview:	Yes
Office ID:	2015120914422160 4156000000
Agent ID:	2015120919312109 6506000000
<input checked="" type="checkbox"/> Foundation:	Raised
<input checked="" type="checkbox"/> Construction Type:	Stick Built
<input checked="" type="checkbox"/> Construction:	Wood Frame
New Construction:	Yes
<input checked="" type="checkbox"/> Service Providers: Sewer Provider:	Brunswick County Public Utilities
Stories:	2
Waterfront:	No
<input checked="" type="checkbox"/> Porch/Balcony/Dec	

Neighborhood

Elementary School:	Jessie Mae Monroe
Middle School:	Shallotte
High School:	West Brunswick

k: Porch, Screened, Patio, Covered

✓ Water Heater: Electric

✓ Attic: Eave Storage

✓ Exterior Finish: Composition

HOA: Yes

SqFt - Heated: 0 Sqft

Lot SqFt: 13,939 Sqft

✓ HOA Amenities: Clubhouse, Maint - Comm Areas, Playground, Fitness Center, Street Lights, Security, Sidewalk, Pickleball, Community Pool, Taxes, Management, Gated, Tennis Court(s)

Garage: 2

## Agent [Info](#)

---



Living Seaside Realty Group

☎ 910-239-3201

☎ +1(910) 227-9439

✉ [home@livingseaside.com](mailto:home@livingseaside.com)

910-239-3201 - 6314 Oleander Dr. Wilmington, NC 28403

---